



---

## Licensing Sub Committee

**Tuesday 4th August 2020**

**10.00 am**

**A virtual meeting via Zoom meeting software**

---

The following members are requested to attend this virtual meeting:

Wes Read

Martin Wale (Chairman)

Karl Gill

This meeting will be recorded and viewable online at the conclusion of the meeting by selecting Licensing Sub-Committee meeting at:

**[https://www.youtube.com/channel/UCSDst3IHGj9WoGnwJGF\\_soA](https://www.youtube.com/channel/UCSDst3IHGj9WoGnwJGF_soA)**

For further information on the items to be discussed, please contact:

[democracy@southsomerset.gov.uk](mailto:democracy@southsomerset.gov.uk)

This Agenda was issued on Tuesday 28 July 2020.

**Alex Parmley, Chief Executive Officer**

# Licensing Sub Committee Membership

Karl Gill

Wes Read

Martin Wale (Chairman)

## Information for the Public

In light of the coronavirus pandemic (COVID-19), the Licensing Sub Committee will meet virtually via video-conferencing to consider and determine reports. For more details on the regulations regarding remote / virtual meetings please refer to the Local Authorities and Police and Crime Panels (Coronavirus) (Flexibility of Local Authority and Police and Crime Panel Meetings) (England and Wales) Regulations 2020 as part of the Coronavirus Act 2020.

The Statutory Licensing Committee has responsibility for all activities under the Licensing Act 2003 and the Gambling Act 2005 except for policies and fees. Established under the Licensing Act 2003, it exercises the functions of the Licensing Authority which itself is the Council.

The Other Licensing Committee can be responsible for all other licensing matters. Established by the Council under discretionary power contained in section 101 of the Local Government Act 1972.

It is lawful for the membership of the two committees to be the same, but they are differently constituted and run under different powers.

Meetings of the Licensing Sub Committee are held as required in the Council Offices, Brympton Way. However during the coronavirus pandemic these meetings will be held remotely via Zoom.

The Council's Constitution is also on the web site and available for inspection in council offices.

Agendas and minutes of meetings are published on the council's website at:  
<http://modgov.southsomerset.gov.uk/ieDocHome.aspx?bcr=1>

Agendas and minutes can also be viewed via the mod.gov app (free) available for iPads and Android devices. Search for 'mod.gov' in the app store for your device, install, and select 'South Somerset' from the list of publishers, then select the committees of interest. A wi-fi signal will be required for a very short time to download an agenda but once downloaded, documents will be viewable offline.

---

Ordnance Survey mapping/map data included within this publication is provided by South Somerset District Council under licence from the Ordnance Survey in order to fulfil its public function to undertake its statutory functions on behalf of the district. Persons viewing this mapping should contact Ordnance Survey copyright for advice where they wish to licence Ordnance Survey mapping/map data for their own use. South Somerset District Council - LA100019471 – 2020

---

# Licensing Sub Committee

**Tuesday 4 August 2020**

## **Agenda**

### ***Preliminary Items***

**1. Declarations of Interests**

In accordance with the Council's current Code of Conduct (adopted July 2012), which includes all the provisions relating to Disclosable Pecuniary Interests (DPI), personal and prejudicial interests, Members are asked to declare any DPI and also any personal interests (and whether or not such personal interests are also "prejudicial") in relation to any matter on the Agenda for this meeting. A DPI is defined in The Relevant Authorities (Disclosable Pecuniary Interests) Regulations 2012 (SI 2012 No. 1464) and Appendix 3 of the Council's Code of Conduct. A personal interest is defined in paragraph 2.8 of the Code and a prejudicial interest is defined in paragraph 2.9. In the interests of complete transparency, Members of the County Council, who are not also members of this committee, are encouraged to declare any interests they may have in any matters being discussed even though they may not be under any obligation to do so under any relevant code of conduct.

**2. Procedure to be followed when considering licensing applications under the Licensing Act 2003 (Pages 4 - 7)**

**3. Representation following the Application for a New Premises License at Forester's Arms, Holywell, East Coker, BA22 9NF (Pages 8 - 44)**

# Agenda Item 2

## **Procedure to be followed when considering Licencing Applications under the Licensing Act 2003**

Pre meeting Prior to the start of the Hearing the Committee Administrator will check that any person wishing to address the Sub-Committee is either an Interested Party or an authorised representative of an Interested Party or a Responsible Body and is entitled therefore to do so.

Where there is any doubt about the person's eligibility to address the sub-Committee, the Committee Administrator will seek advice from the Legal Officer(s).

### **1. The Chairman will introduce:**

- members of the Sub-Committee (which will be made up of three District Councillors);
- the officers present;
- the Parties and their representatives (if any).

**The Chairman will ask**, before starting the Hearing, if any representations are being withdrawn.

### **2. At the start of the hearing the Chairman will advise:-**

- all Parties of the reason for the Hearing and the procedure to be adopted;
- that where a Party wants another person to appear at the Hearing they must ask permission (under Regulation 8(2)) although such permission will not be unreasonably withheld. No permission is needed where the other person is acting only as the Party's representative;
- that if any Party wishes to ask the Sub-Committee to consider documentary or other information at the hearing, which was not provided before the Hearing, then all Parties must consent;
- that if any Party does not attend or is not represented at the hearing, the Hearing can go ahead but the Sub-Committee will consider any application, notice or written representations received by the relevant deadline from that Party;
- that in some circumstances, the Hearing may be adjourned, where the Sub-Committee consider the public interest demands it.

### **3. The Chairman will ask each Party to confirm receipt of the following documents:-**

- Officer's report relating to the case;
- The procedure to be adopted during the Hearing;
- The documents, which the authority is required to provide under the Regulations – this varies according to the type of application but normally this means checking that the applicant has received copies of all the representations made in response to the application notices.

Any queries on the procedure or the factual content of the Licensing Officer's report should be dealt with at this point, with the assistance of the legal officer(s), as required.

4. **The Chairman will then ask** the Licensing Officer to present their report on the application. The report will include confirmation that the requirements as to advertising the application and the serving of notices have been met.
  5. **The Chairman will inform all present - prior to receiving representations** - that each Party will be given an equal amount of time to make their representations. This will normally be a maximum of five minutes. However, the Chairman has discretion about the time given to each Party and may vary the time limit where reasonable to do so although reasons will be given and fairness maintained.
  6. **The Chairman will invite any Responsible Bodies present** e.g. representatives of Police/Fire Service/ Environmental Services to address the Sub-Committee on any relevant representations they have made.
  7. **The Chairman will then invite:**
    - Parties or their representatives speaking in support of the application (including the applicant for the review) to address the Sub-Committee on their relevant representations. The address shall relate only to those matters already raised in the application, representations or notice (as applicable). No new information can be presented at the hearing unless all Parties agree, however, where the authority has notified the Party that it requires clarification on any points, this should be provided at this stage;
    - Parties or their representatives, speaking in opposition to the application for review, to address the Sub-Committee on their relevant representations. The address shall relate only to those matters already raised in the application, representations or notice (as applicable). No new information can be presented at the hearing unless all Parties agree, however, where the authority has notified the Party that it requires clarification on any points, this should be provided at this stage.
- The Chairman** will permit a Member to seek immediate clarification of a point made by a Party, their representative or any another person permitted to attend where, prior to this point in the Hearing, circumstances arise which make it desirable to do so, provided that the question is relevant and helps the proper conduct of the Hearing. The rules of natural justice will be followed.
- No Cross examination will be permitted without the consent of the sub-Committee and this will only be given where Committee considers that cross-examination is required for it to consider the representations, application or notice.
8. **The Chairman will ask** whether anyone has any further relevant comments to make and whether each Party is satisfied with the conduct of the Hearing.
  9. **The Chairman will then invite** Members of the Sub-Committee to ask any questions of any of the Parties or any other person permitted by the Sub-Committee to appear at the Hearing.
  10. **The Chairman will check with the legal adviser(s) that all relevant points have been addressed before asking the Parties to leave the room while** the Sub-Committee consider its decision in private. Only the clerk and the legal adviser(s) will remain with the Sub-Committee although only the sub-committee will be making the decision.
  11. **Once in private the Chairman will advise the other Members** that they must

consider all the information before them in making their decision but will disregard any information which is not relevant to the application, representations or notice and which does not relate to promoting the Licensing Objectives. Members will take account of the Statutory Guidance and the Council's Statement of Licensing Policy but shall be free to depart from it where the merits of the case warrant it. Full reasons shall be given for any such departure. If Members require further information from any Party or any further evidence, they will reconvene the hearing with all Parties able to be present.

12. **The Chairman will ensure, on the Parties return to the Hearing room,** that any legal advice given to the Sub-Committee in private is summarised to the Parties.
13. **The Chairman will notify** all Parties of their decision and the reasons for the decision. The decision will normally be given orally, at the Hearing, in a plain English format to help those attending the Hearing to understand it more easily. This is not the official written Notice of Decision which be sent to all of the Parties shortly afterwards.

Where the Sub-Committee is unable to give a decision at the meeting, **the Chairman will advise all Parties when a decision can be expected.** The decision will be sent to all Parties within the timescales set down in the Regulations.

14. **The Chairman will inform all Parties** of their possible rights of appeal (if any).

## **NOTES**

1. A Party is anyone who has submitted an application or made a relevant representation or served a notice.
2. Where an adjournment is granted the Sub-Committee will notify the Parties forthwith of the date, time and place to which the Hearing has been adjourned.
3. Under no circumstances must the Parties or their witnesses offer Members of the Sub-Committee information in the absence of the other Party. Similarly, Members will not attempt to elicit information from any Party to the Hearing in the absence of the other. Members will not make pronouncements on the merits of the case until all the evidence has been heard. These are essential elements of the rules of natural justice.
4. The Chairman may vary this procedure, as circumstances require but will have regard to the rules of natural justice.
5. The Hearing will take place in public. However, the public can be excluded from all or part of the hearing where the Sub-Committee considers that the public interest in so doing outweighs the public interest in the hearing, or that part of the hearing, taking place in public.

The Sub-Committee may also require a Party to leave the hearing if that Party is behaving in a disruptive manner. The Sub-Committee can refuse to readmit the Party or readmit upon conditions but the Party can nevertheless submit to the Sub-Committee before the end of the Hearing any written information it would have been entitled to submit orally at the Hearing.

6. District Councillors representing the area (District Council Ward) to which the

application refers, or have declared an interest, will not form part of the Sub-Committee.

7. Where any irregularity is brought to the attention of the Sub-Committee during the hearing, the Sub-Committee may, if it feels that a Party has been prejudiced as a result of the irregularity, take such steps as it thinks fit to cure that irregularity before it makes its determination. However, any irregularity from a failure to follow this procedure shall not of itself render the proceedings void and any clerical errors may be corrected.
-

# Agenda Item 3

## **Representation following the Application for a New Premises Licence at Forester's Arms, Holywell, East Coker, BA22 9NF**

*Director:* Netta Meadows – Service Delivery  
*Report Author:* Rachel Lloyd – Licensing Officer  
*Contact Details:* rachel.lloyd@southsomerset.gov.uk or 01935 462134

### **Purpose of the Report**

To inform members that an application has been received from Mr David Edward Wroe for premises licence to be granted under the Licensing Act 2003 at Foresters Arms, Holywell, East Coker, BA22 9NF.

### **Recommendation**

To determine the granting of the premises licence in accordance with the options detailed later in the report.

### **Background**

The Council is the authority responsible for the issue of Premises Licences issued under Section 18 of the Licensing Act 2003.

The Lead Specialist – Environmental Health has delegated authority to determine a Premises Licence application, subject to no objections being received from a Responsible Authority or “Other Persons”. In this case, relevant representations were received from four “Other Persons” it is therefore necessary to convene a hearing to determine the application.

### **Licensing Objectives**

The licensing objectives are:

- Prevention of crime and disorder
- Public safety
- Prevention of public nuisance
- Protection of children from harm

The licensing objectives are to be considered paramount and the Council has a duty to promote them in its decision making process. An application will not be refused in whole or part or any conditions attached except those offered by the applicant or required by law except where appropriate to promote the licensing objectives.

### **Application**

A copy of the application form is enclosed with the agenda; it does not however include a copy of the plan of the premises, which is available for inspection at the Council offices, Brympton Way, Yeovil.

The details of the application are summarised as follows:

- Applicant: Mr David Edward Wroe



Licensable activities applied for:

#### Indoor Sporting Events (C)

Day	Start Time	Finish Time
Monday	11:00	23:00
Tuesday	11:00	23:00
Wednesday	11:00	23:00
Thursday	11:00	23:00
Friday	11:00	00:00
Saturday	11:00	00:00
Sunday	11:00	23:00

Further Details: Skittles, Darts, Pool and Charity Events  
Seasonal Variations: None

Non-Standard Timings: The evening preceding all Bank Holidays and Public Holidays from 23.00 until 01.00 of the day of the Holiday. (Start 11.00 Finish 01.00 the following day). Provision during International sporting events e.g. football/rugby world cups/euros etc. and Olympics which are televised and shown on the premises. Start one hour before the broadcast to allow for events hosted in different time zones and continue throughout and end an hour after the broadcast has ended.

#### Live Music (E) Indoors and Outdoors

Day	Start Time	Finish Time
Monday	-	-
Tuesday	-	-
Wednesday	-	-
Thursday	-	-
Friday	23:00	00:00
Saturday	23:00	00:00
Sunday	-	-

Further Details:

Live performances outside to be limited to a maximum of 12 per year.  
(Awaiting confirmation from the applicant if this means 12 in total, or 12 which go beyond 23:00)

Live music will be unamplified and amplified by bands and solo artists. Noise levels will be monitored and controlled to a reasonable level set by Management.

Non-Standard Timings:

The evening preceding all Bank Holidays and Public Holidays live music to continue inside from 23:00 or 00:00 as applicable until 01.00 on the day of the Holiday (Start 23:00 Finish 01.00).

#### Recorded Music (F) Indoors and Outdoors

Day	Start Time	Finish Time
Monday	-	-
Tuesday	-	-
Wednesday	-	-
Thursday	-	-
Friday	23:00	00:00
Saturday	23:00	00:00
Sunday	-	-

Further Details:

Amplified PA System. Noise levels will be monitored and controlled to a reasonable level set by Management.

Seasonal Variations: None.

Non-Standard Timings:

The evening preceding all Bank Holidays and Public Holidays music to continue inside until 01.00 on the day of the Holiday (Start 23:00 Finish 01:00)

Late Night Refreshment (I) Indoors

Day	Start Time	Finish Time
Monday	23:00	01:00
Tuesday	23:00	01:00
Wednesday	23:00	01:00
Thursday	23:00	01:00
Friday	23:00	01:00
Saturday	23:00	01:00
Sunday	23:00	00:00

Further Details: None

Seasonal Variations: None

Non-Standard Timings:

Provision of food during International sporting events e.g. football/rugby world cups/euros etc. and Olympics which are televised and shown on the premises. Start one hour before the broadcast to allow for events hosted in different time zones and continue throughout and end an hour after the broadcast has ended.

**Supply of Alcohol (J) – Consumption ‘On and Off’ the Premises**

Day	Start Time	Finish Time
Monday	11.00	23.00
Tuesday	11.00	23.00
Wednesday	11.00	23.00
Thursday	11.00	23.00
Friday	11.00	01.00
Saturday	11.00	01.00
Sunday	11.00	23.00

Seasonal Variations: None

Non-Standard Timings:

The evening preceding all Bank Holidays and Public Holidays from 23.00 until 01.00 of the day of the Holiday (Start 11.00 Finish 01.00).

Provision during International sporting events e.g. football/rugby world cups/euros etc. and Olympics which are televised and shown on the premises. Start one hour before the broadcast to allow for events hosted in different time zones and continue throughout and end an hour after the broadcast has ended.

Please highlight any adult entertainment or services, activities, other entertainment or matters ancillary to the use of the premises that may give rise to concern in respect of children. **(K)**

Access to gaming machines will be prevented by anyone unable to prove they are 18 years old with a suitable "Proof of age Card" Refusals will be recorded in the Refusals register.

**Hours premises open to the public (L) – Not a licensable activity, but shown as part of the application.**

Day	Start Time	Finish Time
Monday	07:30	01:30
Tuesday	07:30	01:30
Wednesday	07:30	01:30
Thursday	07:30	01:30
Friday	07:30	01:30
Saturday	07:30	01:30
Sunday	07:30	00:30

**Non-Standard Timings:**

During International sporting events e.g. football/rugby world cups/euros etc. and Olympics which are televised and shown on the premises. Start one hour before the broadcast to allow for events hosted in different time zones and continue throughout and end an hour after the broadcast has ended.

Additional steps put forward by the applicant to comply with licensing objectives. Please see Section M (pages 17 - 18) of the application form; (these where appropriate, will become conditions of the licence, subject to the licence being granted, and are in addition to any further conditions imposed by the Licensing Committee).

Evidence that advertising/notice requirements have been complied with:

- A Locality Officer checked that the notice was on display at the premises on 17 June. The applicant has confirmed that the notice was on display throughout the consultation period. A further notice was placed in the Western Gazette newspaper on 18 June.

**Representations – Responsible Authorities**

- None.

**Representations – Other Persons**

Four representations were received from 'Other Persons]', which relate to concerns about the hours on the application, in particular that they may result in anti-social behaviour such as noise, litter and property damage. Two Other Persons mention that when the premises has previously been licensed they experienced noise nuisance from customers smoking close to their property.

**Relevant Observations**

The premises has previously been licensed, however, the premises licence holder of that licence surrendered the licence in 2019.

The applicant has applied for live and recorded music from 23:00 because if the licence is granted an exemption would apply for live and recorded music within the licensed area (the plan includes the outside areas as being part of the licensed premises, so the exemption would apply to outside areas too).

The applicant has stated that there will be a maximum of 12 occasions per year where live music will be played outside. This would apply to music performed after 23:00.

The applicant has not stated a maximum number of occasions where recorded music would be played in the outside areas.

It is not possible to apply conditions to live and recorded music performed between 08:00 and 23:00 because of the exemption in place.

The non-standard timings in relation to televised international sporting events ask for the supply of alcohol and the hours the premises are open to the public to end at the same time (one hour after the end of the event). No drinking up time has been included on these occasions.

A petition in support of the granting of the application was also received. The person who submitted the petition did not provide their name or address, and the full addresses of the people who signed the petition were not provided, so it was not possible to treat the petition as a relevant representation.

### **Further Information**

Two other persons who made representations have stated that they do not object to the granting of the licence, but would like licensable activities to end at 2300 or 2330.

In determining the application with a view to promoting the licensing objectives in the overall interests of the community, the Committee must have regard to and give appropriate weight to the following considerations:

- Any relevant and valid representation (including supporting documentation received)
- The Latest Guidance issued under s182 of the Act
- The Statement of Licensing Policy issued in January 2014.
- The steps appropriate to promote the licensing objectives as set out in s18(4)
- Human Rights considerations in particular Article 6, Article 8 and Article 1 of Protocol 1

### **Options**

The options available to the committee are stated at section 18 of the Licensing Act 2003 and are as follows:

- Grant the licence subject to such conditions which are consistent with the operating schedule modified to such extent as the Authority considers appropriate for the promotion of the Licensing Objectives and any condition, which must under s19-21, be included in the licence s18(4)(a)(i)(ii) together with the current mandatory conditions.
- Exclude from the scope of the licence any of the licensable activities to which the application relates s18(4)(b)

- Refuse to specify a person in the licence as the premises supervisor s18(4)(c)
- Reject the application s18(4)(d).

## **Right of Appeal**

Schedule 5 of the Licensing Act 2003 sets out the rights and procedures for making appeals against the decision of the Licensing Authority:

Where the Licensing Authority has rejected an application for a premises licence, the applicant may appeal to the Magistrates' Court against the decision to reject.

Where the Licensing Authority has granted the licence, the holder of the licence may appeal to the Magistrates Court against any decision to impose conditions on the licence that are consistent with the operating schedule or imposed where having regard to any relevant representations, are considered appropriate to promote the licensing objectives.

Where the Licensing Authority has granted the licence subject to the exclusion of any of the licensable activities or refused to specify a person as the premises supervisor, the holder of the licence may appeal to the Magistrates Court against the decision.

Where a person who made a relevant representation desires to contend that the licence ought not to have been granted, or that on granting the licence, the Licensing Authority ought to have imposed different or additional conditions, or ought to have taken a step to exclude a licensable activity or refused to have specified a person as the premises supervisor, he may appeal against the decision to the Magistrates Court.

The appellant commences the appeal by giving a notice of appeal to the designated officer for the Magistrates' court within 21 days beginning with the day on which the applicant was notified by the Licensing Authority of the decision appealed against.

On determining the appeal, the court may,

- Dismiss the appeal
- Substitute for the decision appealed against any other decision which could have been made by the Licensing Authority; or
- Remit the case to the Licensing Authority to dispose of it in accordance with the direction of the court.

and may make such order as to costs as it thinks fit.

## **Background Papers**

Licensing Act 2003

SI 2005 No. 44 Licensing Act 2003 (Hearings) (Regulations) 2005

SI 2005 No. 42 Licensing Act 2003 (Premises licences and club premises certificates) Regulations 2005

SI 2010 No.860 Licensing Act 2003 (Mandatory Licensing Conditions) Order 2010

The Latest Guidance issued under section 182 of the Licensing Act 2003.

The Statement of Licensing Policy for South Somerset District Council January 2014.

**Application for a premises licence to be granted under the Licensing Act 2003**

**PLEASE READ THE FOLLOWING INSTRUCTIONS FIRST**

Before completing this form please read the guidance notes at the end of the form. If you are completing this form by hand please write legibly in block capitals. In all cases ensure that your answers are inside the boxes and written in black ink. Use additional sheets if necessary.

You may wish to keep a copy of the completed form for your records.

I/We David Edward Wroe

*(Insert name(s) of applicant)*

**apply for a premises licence under section 17 of the Licensing Act 2003 for the premises described in Part 1 below (the premises) and I/we are making this application to you as the relevant licensing authority in accordance with section 12 of the Licensing Act 2003**

**Part 1 – Premises details**

Postal address of premises or, if none, ordnance survey map reference or description <b>The Forester's Arms Holywell East Coker</b>			
<b>Post town</b>	Yeovil	<b>Postcode</b>	<b>BA22 9NF</b>

Telephone number at premises (if any)	
Non-domestic rateable value of premises	<b>£10,500.00</b>

**Part 2 - Applicant details**

Please state whether you are applying for a premises licence as **Please tick as appropriate**

- a) an individual or individuals \*  please complete section (A)
- b) a person other than an individual \*
  - i as a limited company/limited liability partnership  please complete section (B)
  - ii as a partnership (other than limited liability)  please complete section (B)
  - iii as an unincorporated association or  please complete section (B)
  - iv other (for example a statutory corporation)  please complete section (B)
- c) a recognised club  please complete section (B)
- d) a charity  please complete section (B)

- e) the proprietor of an educational establishment  please complete section (B)
- f) a health service body  please complete section (B)
- g) a person who is registered under Part 2 of the Care Standards Act 2000 (c14) in respect of an independent hospital in Wales  please complete section (B)
- ga) a person who is registered under Chapter 2 of Part 1 of the Health and Social Care Act 2008 (within the meaning of that Part) in an independent hospital in England  please complete section (B)
- h) the chief officer of police of a police force in England and Wales  please complete section (B)

\* If you are applying as a person described in (a) or (b) please confirm (by ticking yes to one box below):

- I am carrying on or proposing to carry on a business which involves the use of the premises for licensable activities; or
- I am making the application pursuant to a  
 statutory function or   
 a function discharged by virtue of Her Majesty's prerogative

**(A) INDIVIDUAL APPLICANTS** (fill in as applicable)

Mr <input checked="" type="checkbox"/>	Mrs <input type="checkbox"/>	Miss <input type="checkbox"/>	Ms <input type="checkbox"/>	Other Title (for example, Rev)	
<b>Surname</b> Wroe			<b>First names</b> David Edward		
<b>Date of birth</b> [REDACTED]		I am 18 years old or over <input checked="" type="checkbox"/> Please tick yes			
<b>Nationality</b> British					
Current residential address if different from premises address		Flat, The Forester's Arms Holywell East Coker			
Post town	YEOVIL			Postcode	BA22 9NF
<b>Daytime contact telephone number</b>		[REDACTED]			
<b>E-mail address (optional)</b>		[REDACTED]			
Where applicable (if demonstrating a right to work via the Home Office online right to work checking service), the 9-digit 'share code' provided to the applicant by that service (please see note 15 for information)					

**SECOND INDIVIDUAL APPLICANT (if applicable)**

Mr <input type="checkbox"/>	Mrs <input type="checkbox"/>	Miss <input type="checkbox"/>	Ms <input type="checkbox"/>	Other Title (for example, Rev)	
<b>Surname</b>			<b>First names</b>		
<b>Date of birth</b>			I am 18 years old or over <input type="checkbox"/> Please tick yes		
<b>Nationality</b>					
Where applicable (if demonstrating a right to work via the Home Office online right to work checking service), the 9-digit 'share code' provided to the applicant by that service: (please see note 15 for information)					
Current residential address if different from premises address					
Post town				Postcode	
<b>Daytime contact telephone number</b>					
<b>E-mail address (optional)</b>					

**(B) OTHER APPLICANTS**

**Please provide name and registered address of applicant in full. Where appropriate please give any registered number. In the case of a partnership or other joint venture (other than a body corporate), please give the name and address of each party concerned.**

Name
Address
Registered number (where applicable)
Description of applicant (for example, partnership, company, unincorporated association etc.)



Telephone number (if any)
E-mail address (optional)

**Part 3 Operating Schedule**

When do you want the premises licence to start? DD MM YYYY

If you wish the licence to be valid only for a limited period, when do you want it to end? DD MM YYYY

<p>Please give a general description of the premises (please read guidance note 1)  Detached Building Public House in a Rural Setting, Beer Garden and Car Park</p>
---

If 5,000 or more people are expected to attend the premises at any one time, please state the number expected to attend.

What licensable activities do you intend to carry on from the premises?

(please see sections 1 and 14 and Schedules 1 and 2 to the Licensing Act 2003)

- | Provision of regulated entertainment (please read guidance note 2)  | Please tick all that apply          |
|---|-------------------------------------|
| a) plays (if ticking yes, fill in box A)  | <input type="checkbox"/>            |
| b) films (if ticking yes, fill in box B)  | <input type="checkbox"/>            |
| c) indoor sporting events (if ticking yes, fill in box C)   | <input checked="" type="checkbox"/> |
| d) boxing or wrestling entertainment (if ticking yes, fill in box D)  | <input type="checkbox"/>            |
| e) live music (if ticking yes, fill in box E)   | <input checked="" type="checkbox"/> |
| f) recorded music (if ticking yes, fill in box F)   | <input checked="" type="checkbox"/> |
| g) performances of dance (if ticking yes, fill in box G)  | <input type="checkbox"/>            |
| h) anything of a similar description to that falling within (e), (f) or (g) (if ticking yes, fill in box H) | <input type="checkbox"/>            |

**Provision of late night refreshment** (if ticking yes, fill in box I)



**Supply of alcohol** (if ticking yes, fill in box J)



**In all cases complete boxes K, L and M**

**A**

<b>Plays</b> Standard days and timings (please read guidance note 7)			<b><u>Will the performance of a play take place indoors or outdoors or both – please tick</u></b> (please read guidance note 3)	Indoors	<input type="checkbox"/>
				Outdoors	<input type="checkbox"/>
				Both	<input type="checkbox"/>
Day	Start	Finish			
Mon			<b><u>Please give further details here</u></b> (please read guidance note 4)		
Tue					
Wed			<b><u>State any seasonal variations for performing plays</u></b> (please read guidance note 5)		
Thur					
Fri			<b><u>Non standard timings. Where you intend to use the premises for the performance of plays at different times to those listed in the column on the left, please list</u></b> (please read guidance note 6)		
Sat					
Sun					

## B

<b>Films</b> Standard days and timings (please read guidance note 7)			<b>Will the exhibition of films take place indoors or outdoors or both – please tick</b> (please read guidance note 3)	Indoors	<input type="checkbox"/>
				Outdoors	<input type="checkbox"/>
				Both	<input type="checkbox"/>
Day	Start	Finish			
Mon			<b>Please give further details here</b> (please read guidance note 4)		
Tue					
Wed			<b>State any seasonal variations for the exhibition of films</b> (please read guidance note 5)		
Thur					
Fri			<b>Non standard timings. Where you intend to use the premises for the exhibition of films at different times to those listed in the column on the left, please list</b> (please read guidance note 6)		
Sat					
Sun					

C

<b>Indoor sporting events</b> Standard days and timings (please read guidance note 7)			<b>Please give further details</b> (please read guidance note 4) Skittles, Darts, Pool & Charity Events
Day	Start	Finish	
Mon	11.00	23.00	<b>State any seasonal variations for indoor sporting events</b> (please read guidance note 5)
Tue	11.00	23.00	
Wed	11.00	23.00	
Thur	11.00	23.00	<b>Non standard timings. Where you intend to use the premises for indoor sporting events at different times to those listed in the column on the left, please list</b> (please read guidance note 6) The evening preceding all Bank Holidays and Public Holidays from 23.00 until 01.00 of the day of the Holiday. (Start 11.00 Finish 01.00 the following day). Provision during International sporting events e.g. football/rugby world cups/euros etc. and Olympics which are televised and shown on the premises one hour before the broadcast to allow for events hosted in different time zones and continue throughout and end an hour after the broadcast has ended.
Fri	11.00	24.00	
Sat	11.00	24.00	
Sun	11.00	23.00	

**D**

<b>Boxing or wrestling entertainments</b> Standard days and timings (please read guidance note 7)			<b><u>Will the boxing or wrestling entertainment take place indoors or outdoors or both – please tick</u></b> (please read guidance note 3)	Indoors	<input type="checkbox"/>
				Outdoors	<input type="checkbox"/>
				Both	<input type="checkbox"/>
Day	Start	Finish			
Mon			<b><u>Please give further details here</u></b> (please read guidance note 4)		
Tue					
Wed			<b><u>State any seasonal variations for boxing or wrestling entertainment</u></b> (please read guidance note 5)		
Thur					
Fri			<b><u>Non standard timings. Where you intend to use the premises for boxing or wrestling entertainment at different times to those listed in the column on the left, please list</u></b> (please read guidance note 6)		
Sat					
Sun					

**E**

<b>Live music</b> Standard days and timings (please read guidance note 7)			<b><u>Will the performance of live music take place indoors or outdoors or both – please tick</u></b> (please read guidance note 3) Live performances outside to be limited to a maximum of 12 per year.	Indoors	<input type="checkbox"/>
				Outdoors	<input type="checkbox"/>
				Both	<input checked="" type="checkbox"/>
Day	Start	Finish			
Mon			<b><u>Please give further details here</u></b> (please read guidance note 4) Live music will be unamplified and amplified by bands and solo artists. Noise levels will be monitored and controlled to a reasonable level set by Management.		
Tue					
Wed			<b><u>State any seasonal variations for the performance of live music</u></b> (please read guidance note 5)		
Thur					
Fri	23.00	24.00	<b><u>Non standard timings. Where you intend to use the premises for the performance of live music at different times to those listed in the column on the left, please list</u></b> (please read guidance note 6) The evening preceding all Bank Holidays and Public Holidays live music to continue inside from 23.00 or 24.00 as applicable until 01.00 on the day of the Holiday (Start 23:00 Finish 01.00).		
Sat	23.00	24.00			
Sun					

**F**

<b>Recorded music</b> Standard days and timings (please read guidance note 7)			<b><u>Will the playing of recorded music take place indoors or outdoors or both – please tick</u></b> (please read guidance note 3)	Indoors	<input type="checkbox"/>
				Outdoors	<input type="checkbox"/>
				Both	<input checked="" type="checkbox"/>
Day	Start	Finish			
Mon			<b><u>Please give further details here</u></b> (please read guidance note 4) Amplified PA System. Noise levels will be monitored and controlled to a reasonable level set by Management.		
Tue					
Wed			<b><u>State any seasonal variations for the playing of recorded music</u></b> (please read guidance note 5)		
Thur					
Fri	23.00	24.00	<b><u>Non standard timings. Where you intend to use the premises for the playing of recorded music at different times to those listed in the column on the left, please list</u></b> (please read guidance note 6) The evening preceding all Bank Holidays and Public Holidays music to continue inside until 01.00 on the day of the Holiday (Start 23:00 Finish 01:00)		
Sat	23.00	24.00			
Sun					



# G

<b>Performances of dance</b> Standard days and timings (please read guidance note 7)			<b><u>Will the performance of dance take place indoors or outdoors or both – please tick</u></b> (please read guidance note 3)	Indoors	<input type="checkbox"/>
				Outdoors	<input type="checkbox"/>
				Both	<input type="checkbox"/>
Day	Start	Finish			
Mon			<b><u>Please give further details here</u></b> (please read guidance note 4)		
Tue					
Wed			<b><u>State any seasonal variations for the performance of dance</u></b> (please read guidance note 5)		
Thur					
Fri			<b><u>Non standard timings. Where you intend to use the premises for the performance of dance at different times to those listed in the column on the left, please list</u></b> (please read guidance note 6)		
Sat					
Sun					

# H

<b>Anything of a similar description to that falling within (e), (f) or (g)</b> Standard days and timings (please read guidance note 7)			Please give a description of the type of entertainment you will be providing		
Day	Start	Finish	<b><u>Will this entertainment take place indoors or outdoors or both – please tick</u></b> (please read guidance note 3)	Indoors	<input type="checkbox"/>
Mon				Outdoors	<input type="checkbox"/>
				Both	<input type="checkbox"/>
Tue			<b><u>Please give further details here</u></b> (please read guidance note 4)		
Wed					
Thur			<b><u>State any seasonal variations for entertainment of a similar description to that falling within (e), (f) or (g)</u></b> (please read guidance note 5)		
Fri					
Sat			<b><u>Non standard timings. Where you intend to use the premises for the entertainment of a similar description to that falling within (e), (f) or (g) at different times to those listed in the column on the left, please list</u></b> (please read guidance note 6)		
Sun					

# I

<b>Late night refreshment</b> Standard days and timings (please read guidance note 7)			<b>Will the provision of late night refreshment take place indoors or outdoors or both – please tick</b> (please read guidance note 3)	Indoors	<input checked="" type="checkbox"/>
Day	Start	Finish		Outdoors	<input type="checkbox"/>
				Both	<input type="checkbox"/>
Mon	23.00	01.00	<b><u>Please give further details here</u></b> (please read guidance note 4)		
Tue	23.00	01.00			
Wed	23.00	01.00	<b><u>State any seasonal variations for the provision of late night refreshment</u></b> (please read guidance note 5)		
Thur	23.00	01.00			
Fri	23.00	01.00	<b><u>Non standard timings. Where you intend to use the premises for the provision of late night refreshment at different times, to those listed in the column on the left, please list</u></b> (please read guidance note 6) Provision of food during International sporting events e.g. football/rugby world cups/euros etc. and Olympics which are televised and shown on the premises one hour before the broadcast to allow for events hosted in different time zones and continue throughout and end an hour after the broadcast has ended.		
Sat	23.00	01.00			
Sun	23.00	24.00			

**J**

<b>Supply of alcohol</b> Standard days and timings (please read guidance note 7)			<b>Will the supply of alcohol be for consumption – please tick</b> (please read guidance note 8)	On the premises	<input type="checkbox"/>
				Off the premises	<input type="checkbox"/>
				Both	<input checked="" type="checkbox"/>
<b>Day</b>	<b>Start</b>	<b>Finish</b>	<b>State any seasonal variations for the supply of alcohol</b> (please read guidance note 5)		
Mon	11.00	23.00			
Tue	11.00	23.00			
Wed	11.00	23.00			
Thur	11.00	23.00			
Fri	11.00	01.00			
Sat	11.00	01.00			
Sun	11.00	23.00	<b>Non standard timings. Where you intend to use the premises for the supply of alcohol at different times to those listed in the column on the left, please list</b> (please read guidance note 6) The evening preceding all Bank Holidays and Public Holidays from 23.00 until 01.00 of the day of the Holiday (Start 11.00 Finish 01.00). Provision during International sporting events e.g. football/rugby world cups/euros etc. and Olympics which are televised and shown on the premises one hour before the broadcast to allow for events hosted in different time zones and continue throughout and end an hour after the broadcast has ended.		

**State the name and details of the individual whom you wish to specify on the licence as designated premises supervisor (Please see declaration about the entitlement to work in the checklist at the end of the form):**

<b>Name</b> [REDACTED]	
<b>Date of birth</b> [REDACTED]	
<b>Address</b> [REDACTED]	
<b>Postcode</b>	[REDACTED]
<b>Personal licence number (if known)</b> [REDACTED]	
<b>Issuing licensing authority (if known)</b> [REDACTED]	

## K

**Please highlight any adult entertainment or services, activities, other entertainment or matters ancillary to the use of the premises that may give rise to concern in respect of children** (please read guidance note 9).

Access to gaming machines will be prevented by anyone unable to prove they are 18 years old with a suitable "Proof of age Card" Refusals will be recorded in the Refusals register.

## L

<b>Hours premises are open to the public</b> Standard days and timings (please read guidance note 7)			<u>State any seasonal variations</u> (please read guidance note 5)
Day	Start	Finish	
Mon	07.30	01.30	
Tue	07.30	01.30	
Wed	07.30	01.30	
Thur	07.30	01.30	
Fri	07.30	01.30	
Sat	07.30	01.30	
Sun	07.30	00.30	

**Non standard timings. Where you intend the premises to be open to the public at different times from those listed in the column on the left, please list** (please read guidance note 6)  
During International sporting events e.g. football/rugby world cups/euros etc. and Olympics which are televised and shown on the premises one hour before the broadcast to allow for events hosted in different time zones and continue throughout and end an hour after the broadcast has ended.

## M

Describe the steps you intend to take to promote the four licensing objectives:

### **a) General – all four licensing objectives (b, c, d and e) (please read guidance note 10)**

We will adopt a Challenge 25 Policy and anyone that appears to be under the age of 25 will be asked for proof of I.D. A register will be kept as evidence.  
A refusals register will be kept updated.  
Staff will be trained how and when to refuse sales of alcohol and the proof of age policy in place at the premises, training will be documented with both the trainer and the trainee signing a document to confirm that the training has been carried out and is understood.

### **b) The prevention of crime and disorder**

A C.C.T.V. System is installed, operated and maintained at the premises in accordance with the current version of Avon & Somerset's Policy "Somerset East District CCTV Systems within Licensed Premises Operational Requirement Guidance" and as endorsed by the Licensing Authority. The CCTV System shall be maintained in working order and continually record when licensable activity takes place.  
Recordings relating to the CCTV cameras shall be kept for a minimum of 28 days and made available to Avon and Somerset Constabulary and Licensing Authority upon request.  
Evidential media for serious incidents (the definition of "serious" to be defined by Avon and Somerset Constabulary) shall be available within 3 hours of such request being made. Such media shall be created by the Premises Licence Holder, a Key Holder or trained Member of Staff, contact numbers of such personnel shall be forwarded to Avon and Somerset Constabulary and updated as required. The Premise License Holder shall ensure that a Staff Policy and sufficient Training are put in place to provide Senior Staff are familiar with the operation of the CCTV equipment.  
Challenge 25 Policy shall be operated at the premises. A refusals register will be maintained at the premises and will be reviewed and audited weekly by the DPS, Premises Licence Holder or owner of the Business. The documents will be made available to Responsible Authorities upon request.  
Maintain membership of the Yeovil Crime Reduction and Pub Watch Team.

### **c) Public safety**

Site safety will be monitored and reviewed.  
Adequate and appropriate first aid equipment will be available and sign posted to their location.  
Regular glass and bottle collections will be carried out by staff.  
Options for plastic cups will be given for children and when using outside areas with children.

### **d) The prevention of public nuisance**

Doors and windows will be kept closed after 22:00 during live and recorded music performances until the end of the performance, except ingress or egress or where closing doors and windows would present a health risk e.g. high temperature  
Signs will be displayed at all exit points requesting patrons respect the local community by leaving quietly.

**e) The protection of children from harm**

Children under the age of 18 must be accompanied by a responsible supervising adult. Anyone that appears to be under the age of 18 will be expected to be with an adult or have I.D. proving their age. Any challenges made by Staff will be entered in the Register.

**Checklist:**

**Please tick to indicate agreement**

- I have made or enclosed payment of the fee.
- I have enclosed the plan of the premises.
- I have sent copies of this application and the plan to responsible authorities and others where applicable.
- I have enclosed the consent form completed by the individual I wish to be designated premises supervisor, if applicable.
- I understand that I must now advertise my application.
- I understand that if I do not comply with the above requirements my application will be rejected.
- [Applicable to all individual applicants, including those in a partnership which is not a limited liability partnership, but not companies or limited liability partnerships] I have included documents demonstrating my entitlement to work in the United Kingdom or my share code issued by the Home Office online right to work checking service (please read note 15).

**IT IS AN OFFENCE, UNDER SECTION 158 OF THE LICENSING ACT 2003, TO MAKE A FALSE STATEMENT IN OR IN CONNECTION WITH THIS APPLICATION. THOSE WHO MAKE A FALSE STATEMENT MAY BE LIABLE ON SUMMARY CONVICTION TO A FINE OF ANY AMOUNT.**

**IT IS AN OFFENCE UNDER SECTION 24B OF THE IMMIGRATION ACT 1971 FOR A PERSON TO WORK WHEN THEY KNOW, OR HAVE REASONABLE CAUSE TO BELIEVE, THAT THEY ARE DISQUALIFIED FROM DOING SO BY REASON OF THEIR IMMIGRATION STATUS. THOSE WHO EMPLOY AN ADULT WITHOUT LEAVE OR WHO IS SUBJECT TO CONDITIONS AS TO EMPLOYMENT WILL BE LIABLE TO A CIVIL PENALTY UNDER SECTION 15 OF THE IMMIGRATION, ASYLUM AND NATIONALITY ACT 2006 AND PURSUANT TO SECTION 21 OF THE SAME ACT, WILL BE COMMITTING AN OFFENCE WHERE THEY DO SO IN THE KNOWLEDGE, OR WITH REASONABLE CAUSE TO BELIEVE, THAT THE EMPLOYEE IS DISQUALIFIED.**

**Part 4 – Signatures** (please read guidance note 11)

**Signature of applicant or applicant’s solicitor or other duly authorised agent** (see guidance note 12). **If signing on behalf of the applicant, please state in what capacity.**

<b>Declaration</b>	<ul style="list-style-type: none"><li>• [Applicable to individual applicants only, including those in a partnership which is not a limited liability partnership] I understand I am not entitled</li></ul>
--------------------	--

	<p>to be issued with a licence if I do not have the entitlement to live and work in the UK (or if I am subject to a condition preventing me from doing work relating to the carrying on of a licensable activity) and that my licence will become invalid if I cease to be entitled to live and work in the UK (please read guidance note 15).</p> <ul style="list-style-type: none"> <li>The DPS named in this application form is entitled to work in the UK (and is not subject to conditions preventing him or her from doing work relating to a licensable activity) and I have seen a copy of his or her proof of entitlement to work, or have conducted an online right to work check using the Home Office online right to work checking service which confirmed their right to work (please see note 15)</li> </ul>
Signature	
Date	08/06/2020
Capacity	Owner

**For joint applications, signature of 2<sup>nd</sup> applicant or 2<sup>nd</sup> applicant's solicitor or other authorised agent** (please read guidance note 13). **If signing on behalf of the applicant, please state in what capacity.**

Signature	
Date	
Capacity	

Contact name (where not previously given) and postal address for correspondence associated with this application (please read guidance note 14)			
Post town		Postcode	
Telephone number (if any)			
If you would prefer us to correspond with you by e-mail, your e-mail address (optional)			



## Notes for Guidance

1. Describe the premises, for example the type of premises, its general situation and layout and any other information which could be relevant to the licensing objectives. Where your application includes off-supplies of alcohol and you intend to provide a place for consumption of these off-supplies, you must include a description of where the place will be and its proximity to the premises.
2. In terms of specific regulated entertainments please note that:
  - Plays: no licence is required for performances between 08:00 and 23.00 on any day, provided that the audience does not exceed 500.
  - Films: no licence is required for 'not-for-profit' film exhibition held in community premises between 08.00 and 23.00 on any day provided that the audience does not exceed 500 and the organiser (a) gets consent to the screening from a person who is responsible for the premises; and (b) ensures that each such screening abides by age classification ratings.
  - Indoor sporting events: no licence is required for performances between 08.00 and 23.00 on any day, provided that the audience does not exceed 1000.
  - Boxing or Wrestling Entertainment: no licence is required for a contest, exhibition or display of Greco-Roman wrestling, or freestyle wrestling between 08.00 and 23.00 on any day, provided that the audience does not exceed 1000. Combined fighting sports – defined as a contest, exhibition or display which combines boxing or wrestling with one or more martial arts – are licensable as a boxing or wrestling entertainment rather than an indoor sporting event.
  - Live music: no licence permission is required for:
    - a performance of unamplified live music between 08.00 and 23.00 on any day, on any premises.
    - a performance of amplified live music between 08.00 and 23.00 on any day on premises authorised to sell alcohol for consumption on those premises, provided that the audience does not exceed 500.
    - a performance of amplified live music between 08.00 and 23.00 on any day, in a workplace that is not licensed to sell alcohol on those premises, provided that the audience does not exceed 500.
    - a performance of amplified live music between 08.00 and 23.00 on any day, in a church hall, village hall, community hall, or other similar community premises, that is not licensed by a premises licence to sell alcohol, provided that (a) the audience does not exceed 500, and (b) the organiser gets consent for the performance from a person who is responsible for the premises.
    - a performance of amplified live music between 08.00 and 23.00 on any day, at the non-residential premises of (i) a local authority, or (ii) a school, or (iii) a hospital, provided that (a) the audience does not exceed 500, and (b) the organiser gets consent for the performance on the relevant premises from: (i) the local authority concerned, or (ii) the school or (iii) the health care provider for the hospital.
  - Recorded Music: no licence permission is required for:

- any playing of recorded music between 08.00 and 23.00 on any day on premises authorised to sell alcohol for consumption on those premises, provided that the audience does not exceed 500.
  - any playing of recorded music between 08.00 and 23.00 on any day, in a church hall, village hall, community hall, or other similar community premises, that is not licensed by a premises licence to sell alcohol, provided that (a) the audience does not exceed 500, and (b) the organiser gets consent for the performance from a person who is responsible for the premises.
  - any playing of recorded music between 08.00 and 23.00 on any day, at the non-residential premises of (i) a local authority, or (ii) a school, or (iii) a hospital, provided that (a) the audience does not exceed 500, and (b) the organiser gets consent for the performance on the relevant premises from: (i) the local authority concerned, or (ii) the school proprietor or (iii) the health care provider for the hospital.
  - Dance: no licence is required for performances between 08.00 and 23.00 on any day, provided that the audience does not exceed 500. However, a performance which amounts to adult entertainment remains licensable.
  - Cross activity exemptions: no licence is required between 08.00 and 23.00 on any day, with no limit on audience size for:
    - any entertainment taking place on the premises of the local authority where the entertainment is provided by or on behalf of the local authority;
    - any entertainment taking place on the hospital premises of the health care provider where the entertainment is provided by or on behalf of the health care provider;
    - any entertainment taking place on the premises of the school where the entertainment is provided by or on behalf of the school proprietor; and
    - any entertainment (excluding films and a boxing or wrestling entertainment) taking place at a travelling circus, provided that (a) it takes place within a moveable structure that accommodates the audience, and (b) that the travelling circus has not been located on the same site for more than 28 consecutive days.
3. Where taking place in a building or other structure please tick as appropriate (indoors may include a tent).
  4. For example the type of activity to be authorised, if not already stated, and give relevant further details, for example (but not exclusively) whether or not music will be amplified or unamplified.
  5. For example (but not exclusively), where the activity will occur on additional days during the summer months.
  6. For example (but not exclusively), where you wish the activity to go on longer on a particular day e.g. Christmas Eve.
  7. Please give timings in 24 hour clock (e.g. 16.00) and only give details for the days of the week when you intend the premises to be used for the activity.
  8. If you wish people to be able to consume alcohol on the premises, please tick 'on the premises'. If you wish people to be able to purchase alcohol to consume away from the premises, please tick 'off the premises'. If you wish people to be able to do both, please tick 'both'.
  9. Please give information about anything intended to occur at the premises or ancillary to the use of the premises which may give rise to concern in respect of children, regardless of whether you intend children to have access to the premises, for example (but not exclusively) nudity or semi-nudity, films for restricted age groups or the presence of gaming machines.
  10. Please list here steps you will take to promote all four licensing objectives together.
  11. The application form must be signed.
  12. An applicant's agent (for example solicitor) may sign the form on their behalf provided that they have actual authority to do so.

13. Where there is more than one applicant, each of the applicants or their respective agent must sign the application form.
14. This is the address which we shall use to correspond with you about this application.

**15. Entitlement to work/immigration status for individual applicants and applications from partnerships which are not limited liability partnerships:**

A licence may not be held by an individual or an individual in a partnership who is resident in the UK who:

- does not have the right to live and work in the UK; or
- is subject to a condition preventing him or her from doing work relating to the carrying on of a licensable activity.

Any premises licence issued in respect of an application made on or after 6 April 2017 will become invalid if the holder ceases to be entitled to work in the UK.

Applicants must demonstrate that they have an entitlement to work in the UK and are not subject to a condition preventing them from doing work relating to the carrying on of a licensable activity. They do this in one of two ways: 1) by providing with this application copies or scanned copies of the documents listed below (which do not need to be certified), or 2) by providing their 'share code' to enable the licensing authority to carry out a check using the Home Office online right to work checking service (see below).

**Documents which demonstrate entitlement to work in the UK**

- An expired or current passport showing the holder, or a person named in the passport as the child of the holder, is a British citizen or a citizen of the UK and Colonies having the right of abode in the UK [please see note below about which sections of the passport to copy].
- An expired or current passport or national identity card showing the holder, or a person named in the passport as the child of the holder, is a national of a European Economic Area country or Switzerland.
- A Registration Certificate or document certifying permanent residence issued by the Home Office to a national of a European Economic Area country or Switzerland.
- A Permanent Residence Card issued by the Home Office to the family member of a national of a European Economic Area country or Switzerland.
- A **current** Biometric Immigration Document (Biometric Residence Permit) issued by the Home Office to the holder indicating that the person named is allowed to stay indefinitely in the UK, or has no time limit on their stay in the UK.
- A **current** passport endorsed to show that the holder is exempt from immigration control, is allowed to stay indefinitely in the UK, has the right of abode in the UK, or has no time limit on their stay in the UK.
- A **current** Immigration Status Document issued by the Home Office to the holder with an endorsement indicating that the named person is allowed to stay indefinitely in the UK or has no time limit on their stay in the UK, **when produced in combination with** an official document giving the person's permanent National

Insurance number and their name issued by a Government agency or a previous employer.

- A birth or adoption certificate issued in the UK, **when produced in combination with** an official document giving the person's permanent National Insurance number and their name issued by a Government agency or a previous employer.
- A birth or adoption certificate issued in the Channel Islands, the Isle of Man or Ireland **when produced in combination with** an official document giving the person's permanent National Insurance number and their name issued by a Government agency or a previous employer.
- A certificate of registration or naturalisation as a British citizen, **when produced in combination with** an official document giving the person's permanent National Insurance number and their name issued by a Government agency or a previous employer.
- A **current** passport endorsed to show that the holder is allowed to stay in the UK and is currently allowed to work and is not subject to a condition preventing the holder from doing work relating to the carrying on of a licensable activity.
- A **current** Biometric Immigration Document (Biometric Residence Permit) issued by the Home Office to the holder which indicates that the named person can currently stay in the UK and is allowed to work relation to the carrying on of a licensable activity.
- A **current** Residence Card issued by the Home Office to a person who is not a national of a European Economic Area state or Switzerland but who is a family member of such a national or who has derivative rights or residence.
- A **current** Immigration Status Document containing a photograph issued by the Home Office to the holder with an endorsement indicating that the named person may stay in the UK, and is allowed to work and is not subject to a condition preventing the holder from doing work relating to the carrying on of a licensable activity **when produced in combination with** an official document giving the person's permanent National Insurance number and their name issued by a Government agency or a previous employer.
- A Certificate of Application, **less than 6 months old**, issued by the Home Office under regulation 18(3) or 20(2) of the Immigration (European Economic Area) Regulations 2016, to a person who is not a national of a European Economic Area state or Switzerland but who is a family member of such a national or who has derivative rights of residence.
- Reasonable evidence that the person has an outstanding application to vary their permission to be in the UK with the Home Office such as the Home Office acknowledgement letter or proof of postage evidence, or reasonable evidence that the person has an appeal or administrative review pending on an immigration decision, such as an appeal or administrative review reference number.

- Reasonable evidence that a person who is not a national of a European Economic Area state or Switzerland but who is a family member of such a national or who has derivative rights of residence in exercising treaty rights in the UK including:
  - evidence of the applicant’s own identity – such as a passport,
  - evidence of their relationship with the European Economic Area family member – e.g. a marriage certificate, civil partnership certificate or birth certificate, and
  - evidence that the European Economic Area national has a right of permanent residence in the UK or is one of the following if they have been in the UK for more than 3 months:
    - (i) working e.g. employment contract, wage slips, letter from the employer,
    - (ii) self-employed e.g. contracts, invoices, or audited accounts with a bank,
    - (iii) studying e.g. letter from the school, college or university and evidence of sufficient funds; or
    - (iv) self-sufficient e.g. bank statements.

Family members of European Economic Area nationals who are studying or financially independent must also provide evidence that the European Economic Area national and any family members hold comprehensive sickness insurance in the UK. This can include a private medical insurance policy, an EHIC card or an S1, S2 or S3 form.

**Original documents must not be sent to licensing authorities.** If the document copied is a passport, a copy of the following pages should be provided:

- (i) any page containing the holder’s personal details including nationality;
- (ii) any page containing the holder’s photograph;
- (iii) any page containing the holder’s signature;
- (iv) any page containing the date of expiry; and
- (v) any page containing information indicating the holder has permission to enter or remain in the UK and is permitted to work.

If the document is not a passport, a copy of the whole document should be provided.

Your right to work will be checked as part of your licensing application and this could involve us checking your immigration status with the Home Office. We may otherwise share information with the Home Office. Your licence application will not be determined until you have complied with this guidance.

### **Home Office online right to work checking service**

As an alternative to providing a copy of the documents listed above, applicants may demonstrate their right to work by allowing the licensing authority to carry out a check with the Home Office online right to work checking service.

To demonstrate their right to work via the Home Office online right to work checking service, applicants should include in this application their 9-digit share code (provided to them upon accessing the service at <https://www.gov.uk/prove-right-to-work>) which, along with the applicant’s date of birth (provided within this application), will allow the licensing authority to carry out the check.

In order to establish the applicant’s right to work, the check will need to indicate that the applicant is allowed to work in the United Kingdom and is not subject to a condition preventing them from doing work relating to the carrying on of a licensable activity.

An online check will not be possible in all circumstances because not all applicants will have an immigration status that can be checked online. The Home Office online right to work checking service sets out what information and/or documentation applicants will need in order to access the service. Applicants who are unable to obtain a share code from the service should submit copy documents as set out above.

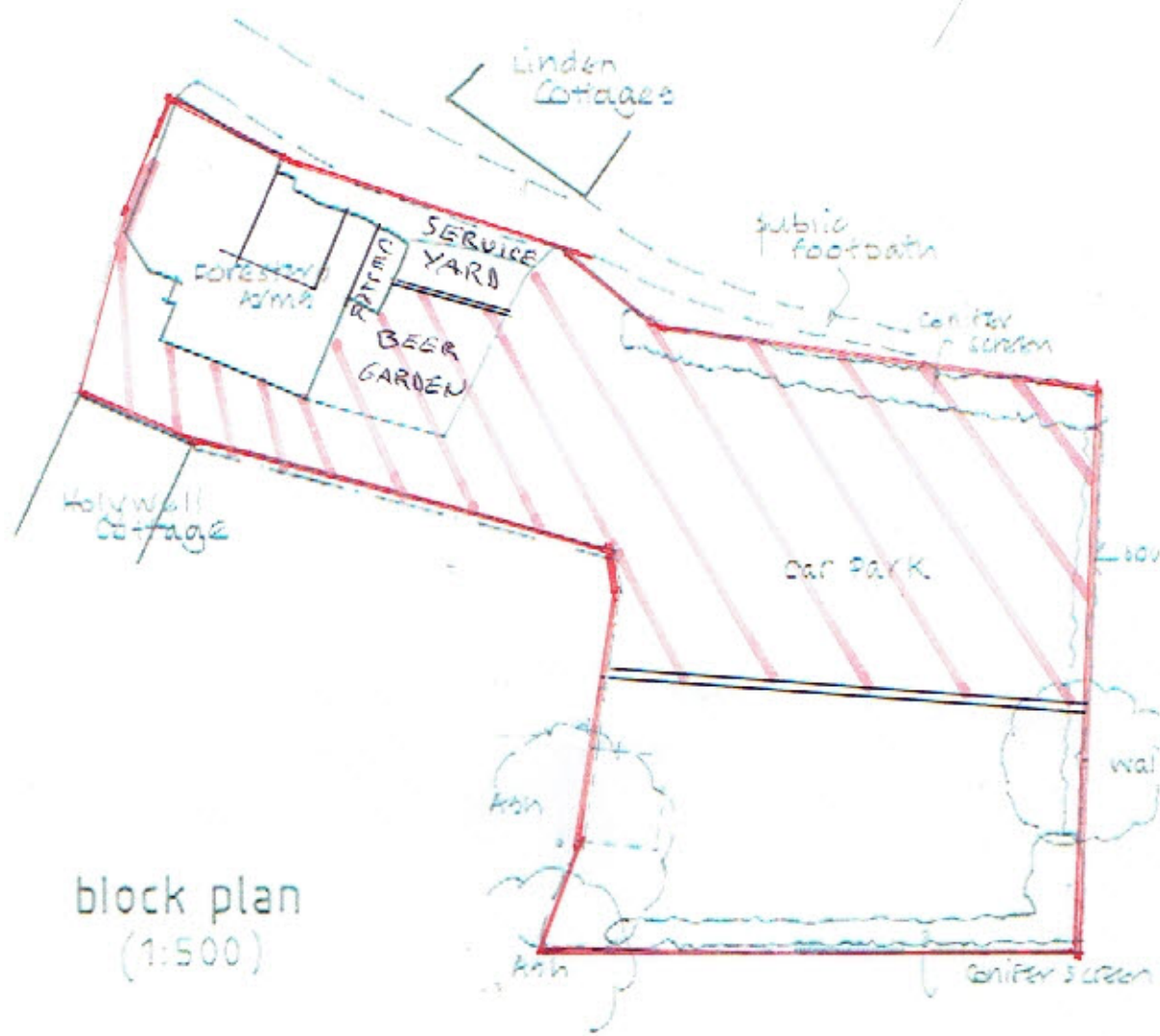
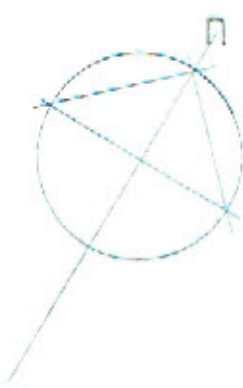

block plan  
(1:500)

THE FORESTER'S ARMS  
 HOLYWELL  
 EAST CORNER  
 YEODIL  
 BA22 9NF  
 18/05/2020

SCALE 1:100

FIRE SYMBOL LEGEND

- FIRE ALARM CALL POINT
- ⊞ EMERGENCY LIGHTING
- ⊞ FE FIRE EXTINGUISHER
- ⊞ FB FIRE BLANKET
- MOE MEANS OF ESCAPE DOOR WITH SIGN OVER. DOORS FITTED WITH ESCAPE PROMONGERY

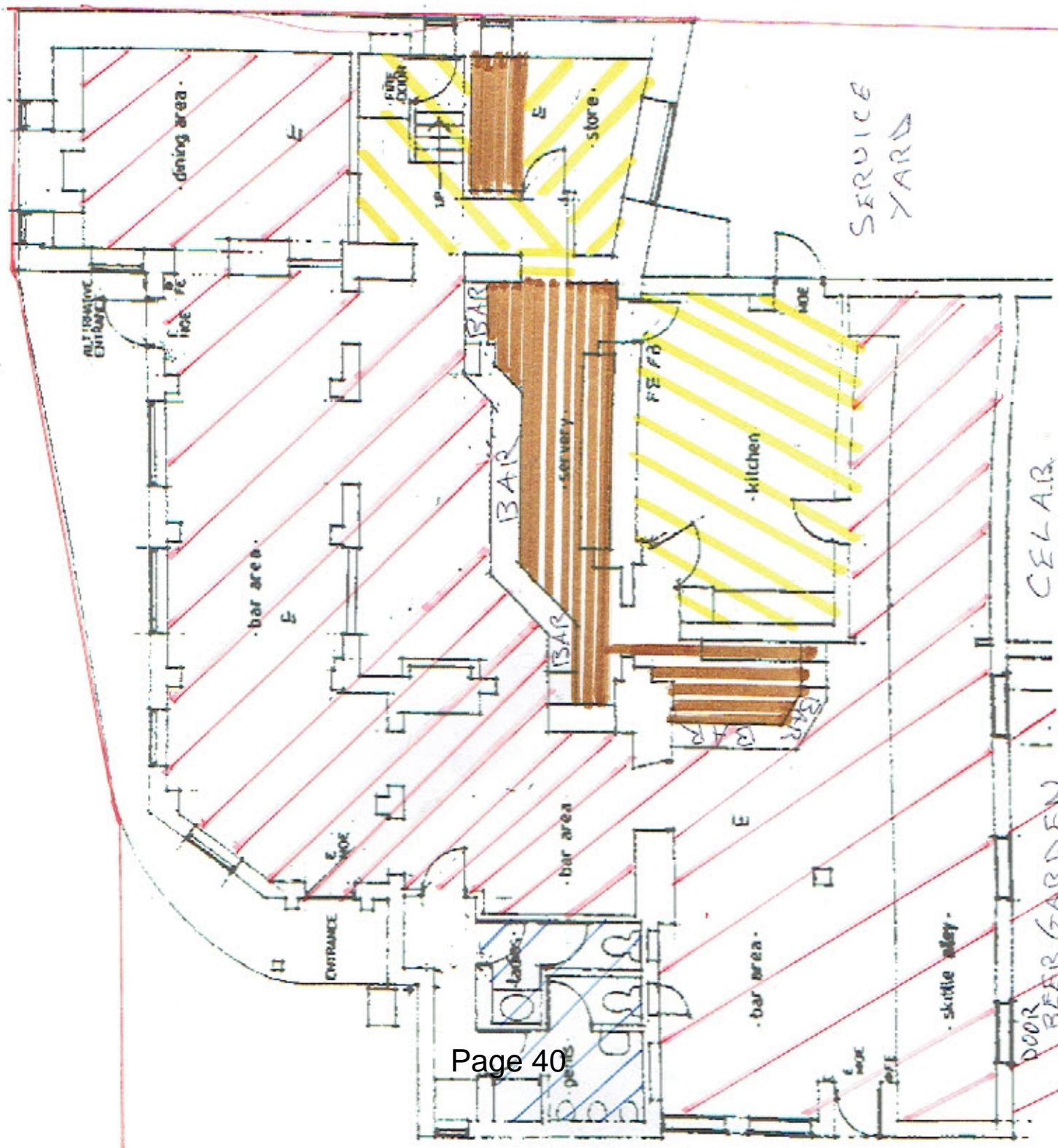



By virtue of paragraph(s) 3 of Part 1 of Schedule 12A  
of the Local Government Act 1972.

Document is Restricted

By virtue of paragraph(s) 3 of Part 1 of Schedule 12A  
of the Local Government Act 1972.

Document is Restricted